

BASIC WATERPROOFING MEMBRANE (FOUNDATION)

WATERPROOFING MEMBRANE

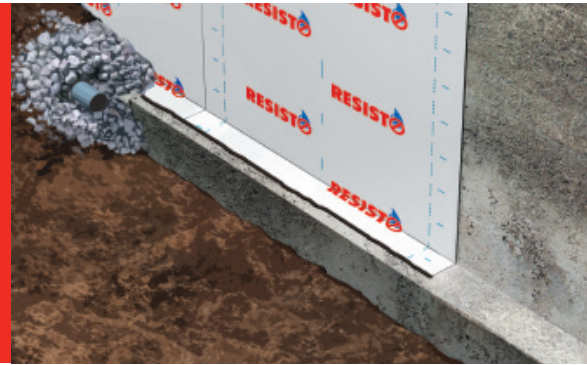

Self-adhesive membrane mainly used as an underlay in a two-layer roofing system as well as for waterproofing foundations, shower bases and washrooms.

- Versatile for a variety of applications
- Excellent resistance to temperature variations
- Excellent tear resistance

PRODUCT PURPOSE

Application	Waterproofing	
Building Part	Foundation	
Substrates	Treated wood	Masonry block
	PWF	Concrete

PRODUCT CHARACTERISTICS

Technology	SBS modified bitumen
Surface	Trilaminate woven polyethylene
Underface	Silicone release film
Installation Method	Self-adhesive
Operating Temperatures	-40 °C to 90 °C (-40 ° to 194 °F)
Maximum exposure	90 days

PACKAGING

Code	Width		Length		Thickness		Selvage Width	Net Area		Brute Area		Quantity (per pallet)
	m	in	m	ft	mm	mils	mm	m ²	ft ²	m ²	ft ²	
65242	1	39	7	22.97	1.5	60	100	6.30	67.81	7.00	75.35	60
65241	1	39	10	32.81	1.5	60	100	9.00	96.88	10.00	107.64	36
15254	1	39	20	65.62	1.5	60	100	18.00	193.75	20.00	215.28	25
15249	1	39	20	65.62	1.5	60	100	18.00	193.75	20.00	215.28	25
61000 (Waterproofing Repair Kit For Foundation Cracks)	EXTERIOR PRIMER 910 ml (30 oz) BASIC WATERPROOFING MEMBRANE 50 cm x 7 m (20 in X 23 ft) ELASTOMERIC SEALANT 310 ml (10 oz) Brush and gloves											





PROPERTIES

Properties	STANDARDS	BASIC WATERPROOFING MEMBRANE
Tensile Strength, MD/XD	ASTM D5147	11.3 / 15.4 kN/m (64 / 88 lbf/in)
Ultimate Elongation, MD/XD	ASTM D5147	52 / 24%
Tear Resistance, MD/XD	ASTM D5601	375 / 400 N (84 / 90 lbf)
Static Puncture	ASTM D5602	400 N (90 lbf)
Lap Adhesion	ASTM D1876	2000 N/m (11.4 lbf/in)

For CCMC product evaluation in compliance with CGSB 37-GP-56M, see CCMC Evaluation Listing #13288-L.
 For Foundations Applications, see CCMC Evaluation Listing #13562-R.
 (All values are nominal)

BASIC WATERPROOFING MEMBRANE (FOUNDATION)

INSTALLATION

Storage	Rolls should be stored upright, tape side up. If the products are stored outdoors, cover them with an opaque protective cover after removing the delivery packaging. Can withstand freezing but must be reactivated to at least 10 °C (50 °F) before installation.		
Minimum Application Temperature	10 °C (50 °F) -10 °C (14 °F) for the cold temperature version		
Products Required	EXTERIOR PRIMER	OR H ₂ O PRIMER	
	OR PRIMER LOW VOC	AND BLACK ELASTOMERIC SEALER	
Tools Required	 Smoothing roller	 Roller	
	 Trowel	 Paint brush	
	 Knife		
Surface Preparation	The substrate must be clean, dry and free of dust, grease or other contaminants.		
Installation	<ol style="list-style-type: none"> 1. Prime the substrate with EXTERIOR PRIMER or H₂O PRIMER. 2. Install a gusset (small cut of membrane) on all interior or exterior corners of the foundation that will be covered by the BASIC MEMBRANE SEALER. 3. Measure the height of the foundation to be covered (10 cm or 4 in under the ground level) and cut a membrane strip of this dimension, then cut that part in half to get two strips which will be used to cover the corners. 4. Cover the corners of the foundation laying a membrane strip to reinforce the inside or outside angles from the foundation. It is important to position the membrane by sticking one side at a time. 5. Begin installation of the membrane from one corner, from the top down. 6. Remove a 10 cm (4 in) piece of the paper back from the underface to adhere the upper portion of the membrane to the support. This will allow the membrane to stick to the foundation by itself. 7. Continue to remove the protective film and press the membrane well, with a rubber roller, to increase adhesion. 8. Provide an overlap of 10 cm (4 in) between each membrane edge (a dotted line on the membrane indicates the overlap area). 9. At the bottom of the wall, the membrane must cover 2/3 of the footing. 10. To complete the seal, apply ELASTOMERIC SEALER at the top of the membrane around the foundation and at the bottom of footing to prevent water infiltration. 		
Tricks / Tips	In the case of rocky or clay soils, a protective panel such as a rigid insulation panel must be installed before backfilling (such as SOPRA-XPS). If the substrate is concrete, ensure that the curing period is sufficient before installing the membrane. To install a dimpled membrane over the BASIC WATERPROOFING MEMBRANE please contact the RESISTO technical service.		
Recommendations/ Limitations	<p>It is not recommended to use a product containing bitumen directly on softwood boards or flexible polyvinyl chloride.</p> <p>When waterproofing foundation, backfill should be free of debris to ensure proper water drainage towards the drain. It is the sole responsibility of the user to ensure that the products are installed according to the applicable Building Codes and the requirements of local authorities.</p>		