

A person wearing a white protective suit and mask is holding a box with a large 'R' logo. The box also has text that reads 'MA BASE' and 'CHD'. The background is dark and textured.

PRODUCT CATALOG

RESISTO®



Representative: _____

Phone: _____

Email: _____



RESISTO, a division of SOPREMA, specializes in the manufacturing of construction products. Whether for waterproofing, insulation or maintenance, RESISTO offers products and solutions that are accessible, easy-to-install, and professional quality. Every year, thousands of contractors and consumers choose RESISTO for the quality of its products and its personalized service.

WARRANTIES

Choosing RESISTO is a guarantee of reliability. To demonstrate the unique performance of its products, RESISTO offers a comprehensive warranty program that lives up to its reputation and expertise.



TABLE OF CONTENTS



SYSTEMS	6
----------------	----------

WATERPROOFING	8
----------------------	----------

ROOFING	9
---------	---

FOUNDATIONS	13
-------------	----

WALLS	15
-------	----

DOORS AND WINDOWS	16
-------------------	----

DECKS AND BALCONIES	17
---------------------	----

WATERPROOFING COMPLEMENTS	18
---------------------------	----

INSULATION	20
-------------------	-----------

REFLECTIVE INSULATION	21
-----------------------	----

MAINTENANCE	24
--------------------	-----------

SOPREMA INSULATION	28
---------------------------	-----------

SOPREMA SOUNDPROOFING	36
------------------------------	-----------

ALSAN – SOPREMA FOAMS AND SEALANTS	40
---	-----------

CHEM LINK	44
------------------	-----------

RESISTO
SYSTEMS

RESISTO

TWO-PLY SYSTEM

To waterproof a roof with a low exterior slope, a two-ply system composed of a base sheet membrane combined with a granulated cap sheet membrane is the optimal solution.

- EXTERIOR PRIMER
- SELF-ADHERED WATERPROOFING MEMBRANE
- AIR AND VAPOR BARRIER MEMBRANE – REDZONE
- GRANULATED CAP SHEET
– HIGH RESISTANCE
– HR CAP SHEET
- ELASTOMERIC SEALANT

20-YEAR WARRANTY

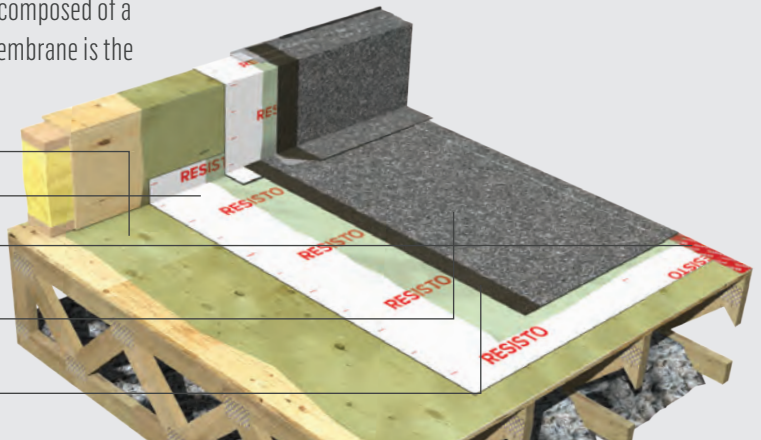

DUOLAP SYSTEM

Contact your RESISTO representative to find out more about the DUOLAP system: a two-ply system combining the waterproofing properties and durability of SBS bitumen membranes. Duo Selvedge Technology.

The system is covered by a 20-year manufacturer's warranty, provided it is installed by a certified installer and all warranty conditions are met.

20-YEAR WARRANTY



TRAINING

Developed and given by RESISTO's technical advisers, this full-day training session covers the theory and best practices used for the installation of the DUOLAP system according to RESISTO standards.

A construction worker wearing a dark jacket, blue jeans, and a tool belt is standing on a roof. They are holding a large roll of white waterproofing material. The background shows a cloudy sky and the structure of the roof. The text 'TOP SECRET' is overlaid in large, semi-transparent letters on the left side of the image.

TOP SECRET

WATERPROOFING

WATERPROOFING

ROOFS

* LEGEND (codes)

NB: Without box LT: Low temperature

ICE AND WATER PROTECTOR

LB1236/LB1244

LB1236 is a 1.35 mm self-adhesive waterproofing membrane made of elastomeric SBS bitumen with a glass mat reinforcement. The surface is sanded and the underface is composed of a silicone film easily detachable in two parts.

INTENDED USES:

- Steep exterior slopes
- Asphalt shingles

CODES:

00822 – 91 cm × 20 m (36" × 65') NB
00844 – 91 cm × 24.4 m (36" × 80') NB
00911 – 1.12 m × 22.8 m (44" × 75') NB
00941 – 1.12 m × 18.7 m (44" × 61.2') NB



BENEFITS

- Anti-slip sanded surface
- Self-sealing around screws and nails
- Resistant to outdoor temperature changes

ICE AND WATER PROTECTOR

LASTOBOND SANDED FINISH

LASTOBOND SANDED FINISH is a 1.6 mm self-adhesive waterproofing membrane made of elastomeric SBS bitumen with a glass mat reinforcement. The surface is sanded and the underface is composed of a silicone film easily detachable in two parts.

INTENDED USES:

- Steep exterior slopes
- Asphalt shingles

CODES:

00166 – 91 cm × 10 m (36" × 33')
00167 – 91 cm × 20 m (36" × 65')
0090302 – 45.5 cm × 20 m (18" × 65') NB
00151 – 91 cm × 20 m (36" × 65') NB
00159 – 91 cm × 24.4 m (36" × 80') NB



BENEFITS

- Anti-slip sanded surface
- Self-sealing around screws and nails
- Resistant to outdoor temperature changes

HIGH TEMPERATURE REINFORCED ROOF UNDERLAYMENT

LASTOBOND SMOOTH SEAL HT

LASTOBOND SMOOTH SEAL HT is a 1.2 mm self-adhesive waterproofing membrane made of elastomeric SBS bitumen and a glass mat reinforcement. The surface is an anti-slip plastic film and the underface is a silicone film easily detachable in two parts.

INTENDED USES:

- Steep exterior slopes
- Asphalt shingles
- Metal roofing

CODE:

00959 – 91 cm × 20 m (36" × 65') NB

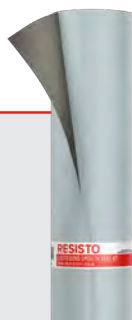

BENEFITS

- Resistant to high temperatures up to 115 °C (240 °F)
- UV resistant (60-day exposure)
- Great tensile strength
- Self-sealing around screws and nails

HIGH TEMPERATURE ROOF UNDERLAYMENT

LASTOBOND PRO HT-N

LASTOBOND PRO HT-N is a 1 mm self-adhesive waterproofing membrane made of elastomeric SBS bitumen and a trilaminate woven polyethylene surface. The underface is composed of a silicone film easily detachable in two parts. The membrane is ideal under all types of cladding.

INTENDED USES:

- Steep and low exterior slopes
- Asphalt shingles
- Metal roofing
- Single-ply roofing system

CODES:

10107 – 91 cm × 20 m (36" × 65')
10007 – 91 cm × 20 m (36" × 65') NB



BENEFITS

- Ideal for under metal roofing
- Anti-slip surface
- Self-sealing around screws and nails
- Resistant to high temperatures up to 90 °C (194 °F)

EAVE PROTECTOR

ROOF UNDERLAYMENT

HIGH TEMPERATURE ROOF UNDERLAYMENT LASTOBOND PRO HT-S

LASTOBOND PRO HT-S is a 1 mm self-adhesive waterproofing membrane made of elastomeric SBS bitumen and a trilaminate woven polyethylene surface. The underface is composed of a silicone film easily detachable in two parts. The membrane is ideal under all types of cladding.

INTENDED USES:

- Steep and low exterior slopes
- Asphalt shingles
- Metal roofing
- Single-ply roof system

CODES:

10108 – 91 cm × 20 m (36" × 65')
10009 – 91 cm × 20 m (36" × 65') NB



BENEFITS

- Anti-slip surface
- Self-sealing around screws and nails
- Resistant to high temperatures up to 126 °C (260 °F)

ROOF UNDERLAYMENT LASTOBOND PRO LT

LASTOBOND PRO LT is a 1 mm self-adhesive waterproofing membrane made of elastomeric SBS bitumen and a trilaminate woven polyethylene surface. The underface is a silicone film easily detachable in two parts. The membrane is ideal under all types of cladding.

INTENDED USES:

- Steep and low exterior slopes
- Asphalt shingles
- Metal roofing

CODE:

10104 – 91 cm × 20 m (36" × 65') NB



BENEFITS

- Can be installed up to -10 °C (14 °F)
- Anti-slip surface
- Self-sealing around screws and nails
- Resistant to high temperatures up to 90 °C (194 °F)

SHINGLE UNDERLAYMENT RESISTOFLEX

RESISTOFLEX is a 1.4 mm roofing underlayment membrane made of elastomeric SBS bitumen and a glass mat reinforcement. The surface and the underface are sanded. This membrane is used as an additional waterproofing component under the roofing.

INTENDED USES:

- Steep exterior slopes
- Asphalt shingles

CODES:

00943 – 91 cm × 10 m (36" × 33')
00931 – 1.12 m × 20 m (44" × 65')

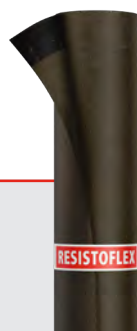

BENEFITS

- Anti-slip sanded surface
- Self-sealing around screws and nails
- Resistant to outdoor temperature changes

SYNTHETIC ROOFING UNDERLAYMENT RESISTOR

RESISTOR is a synthetic roofing underlayment membrane. The surface of the membrane is made of anti-slip, embossed non-woven polyolefin. As for the underface, it is reinforced with woven polymer. It can be used as a complement to the installation of an eave protector.

INTENDED USES:

- Steep exterior slopes
- Asphalt shingles
- Metal roofing

CODE:

21758 – 1.07 m × 87 m (42" × 286')



BENEFITS

- Larger coverage per roll
- Wrinkle free and flexible at low temperature for easy installation
- A nailing pattern is printed on the surface for easy installation

SYNTHETIC ROOFING UNDERLAYMENT RESISTOR SF

RESISTOR SF is a lightweight, non-slip synthetic membrane composed of a non-woven polyolefin surface and a polymer reinforced woven polyolefin underside. It can be used as a complement to the installation of an eave protector.

INTENDED USES:

- Steep exterior slopes
- Asphalt shingles
- Metal roofing

CODE:

22353 – 1.07 m × 87 m (42" × 286')



BENEFITS

- Anti-slip
- Much lighter and stronger than felt paper
- Tensile strength and tear resistance

SYNTHETIC ROOFING UNDERLAYMENT RESISTOR 15

RESISTOR 15 is a light synthetic membrane made of woven polypropylene with an anti-slip thermoplastic polyolefin coating. It can be used as a complement to the installation of an eave protector.

INTENDED USES:

- Steep exterior slopes
- Asphalt shingles
- Metal roofing

CODE:

22477 – 1.22 m × 76.2 m (48" × 250')



BENEFITS

- Woven polypropylene substrate highly resistant to traction and tearing
- At least five times lighter than 30 lb (13.6 kg) felt board
- Each roll covers a surface 4.6 times larger than felt boards

SYNTHETIC ROOFING UNDERLAYMENT RESISTOR PLUS

RESISTOR PLUS is a synthetic roof underlayment made of polyolefin, which is woven polypropylene and polyethylene. Both strong and lightweight, RESISTOR PLUS is highly slip resistant, whether wet or dry, and can be installed during summer or winter. It can be used as a complement to the installation of an eave protector.

INTENDED USES:

- Steep exterior slopes
- Asphalt shingles
- Metal roofing

CODES:
20802 – 30 cm × 76 m (12" × 250')
20556 – 1 m × 46 m (40" × 150')
22468 – 1.5 m × 61 m (60" × 200')

BENEFITS

- Nine times lighter than felt paper
- Five times stronger than felt paper
- Durable



SOPRAVAP'R VAPOR BARRIER MEMBRANE

Self-adhesive vapour barrier membrane composed of a tri-laminated woven polyethylene facer and SBS modified bitumen. The underface is covered with a silicone release film.

INTENDED USES:

- Low exterior slopes
- Very low exterior slopes
- Interior slopes

CODE:
14201 – 1,14 m × 40,8 m (45" × 133,9')

BENEFITS

- Fast and easy-to-install
- Support panel not required
- The width of the membrane (1.14 m [45 in]) was determined so that it fits with the top of most steel deck profiles. Wastage is then reduced and, at the same time, the area covered by a roll is increased.



LOW SLOPES

HIGH RESISTANCE GRANULATED CAP SHEET HR CAP SHEET

The HR CAP SHEET is a 3.8 mm self-adhesive waterproofing membrane made of elastomeric SBS bitumen reinforced with a high resistance (HR) composite reinforcement and a coloured granule surface. The underface is composed of a silicone film easily detachable in two parts. This membrane is used with RESISTO single-ply and two-ply low-slope roof waterproofing systems.

INTENDED USES:

- Low exterior slopes
- Single-ply roofing system
- Two-ply roofing system

CODES:
09151 – 1 m × 7 m (39" × 22.9') GREEN
09141 – 1 m × 7 m (39" × 22.9') BLACK
09131 – 1 m × 7 m (39" × 22.9') GRAY
09101 – 1 m × 7 m (39" × 22.9') BROWN

BENEFITS

- High strength composite reinforcement
- No specialized tools required
- Durable

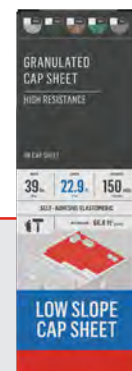

SEMI-RIGID ASPHALTIC BOARD SOPRABOARD

Support panel adhered with hot bitumen, DUOTACK adhesive or mechanically fastened composed of a mineral-fortified asphaltic core, formed between two layers of asphalt saturated of glass mat.

INTENDED USES:

- Low exterior slopes

CODES:
08410 – 1.22 m × 1.52 m (4'x5') × 1/8"
08411 – 1.22 m × 1.52 m (4'x5') × 1/4"
08412 – 1.22 m × 1.22 m (4'x4') × 1/8"
08413 – 1.22 m × 2.44 m (4'x8') × 3/16"
08414 – 1.22 m × 1.22 m (4'x4') × 3/16"
08415 – 1.22 m × 2.44 m (4'x8') × 1/8"
08416 – 1.22 m × 1.22 m (4'x4') × 1/4"
08419 – 1.22 m × 2.44 m (4'x8') × 1/8"

BENEFITS

- Excellent resistance against puncture
- High dimensional stability



SELF-ADHERED WATERPROOFING MEMBRANE BASIC WATERPROOFING MEMBRANE

The BASIC WATERPROOFING MEMBRANE is a 1.5 mm self-adhesive membrane made of elastomeric SBS bitumen and trilaminated woven polyethylene. The underface is composed of a silicone film easily detachable. This membrane is mainly used as a base sheet in two-ply roofing systems as well as for the waterproofing of foundations, shower bases, and washrooms.

INTENDED USES:

- Two-ply roofing system
- Foundations
- Showers and washrooms

CODES:
6524201 – 50 cm × 7 m (20" × 23')
65241 – 1 m × 10 m (39" × 33')
15256 – 1 m × 18.6 m (39" × 61')

BENEFITS

- Great tear resistance
- Self-sealing
- Low-temperature grade also available



SOPRAPLY STICK TRAFFIC CAP

Self-adhesive high performance cap sheet membrane with a composite reinforcement and SBS modified bitumen.

INTENDED USES:

- Low exterior slopes
- Interior negative slopes with drain
- Duolap roofing system

CODES:

09200 – 10 m × 1 m (33" x 3.3') GREY
09202 – 10 m × 1 m (33" x 3.3') BROWN
09203 – 10 m × 1 m (33" x 3.3') LIGHT BLACK
09204 – 10 m × 1 m (33" x 3.3') BLACK
09200 – 10 m × 1 m (33" x 3.3') SIENNA

BENEFITS

- Various possible combinations of SOPREMA products
- Platinum Privilege Warranty for up to 20 years
- Composite reinforcement allows matchless dimensional stability



HIGH-DENSITY SUPPORT PANEL DUOBOARD SANDED

DUOBOARD SANDED is a high-performance, high-density support panel consisting of an elastomeric SBS bitumen membrane factory laminated on an asphaltic board.

INTENDED USES:

- Low exterior slopes
- Interior negative slopes with drain

CODE:

09961 – 91 cm × 2,44 m (3' × 8')

NON-FIBROUS ROOF COATING

The NON-FIBROUS ROOF COATING is composed of bitumen and fast-evaporating solvent. It is completely waterproof and may also be in contact with roof details (concrete chimneys, metallic flashings, etc.).

INTENDED USES:

- Flat asphalt and gravel roof

CODES:

53020 – 3.78 L (1 gal)
53021 – 18.9 L (5 gal)

BENEFITS

- Superior sealing due to the DUO SELVEDGE technology
- Quick installation: 2 products in 1
- Flexible

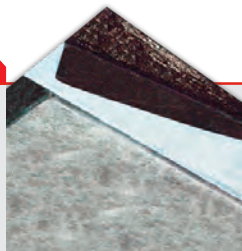

BENEFITS

- Extends the service life of multilayer roofs
- Cures quickly
- Adheres to several materials without primer



FIBROUS ROOF COATING

The FIBROUS ROOF COATING is composed of selected bitumen, fast-evaporating solvent, cellulosic fibres, and mineral fillers. It is designed to restore existing multilayer asphalt roofs to extend their service life.

INTENDED USES:

- Low slope asphalt and gravel roof

CODES:

53030 – 3.78 L (1 gal)
53031 – 18.9 L (5 gal)

ALUMINUM ROOF COATING

The ALUMINUM ROOF COATING is a thick, homogeneous coating made of elastomeric bitumen, volatile solvents, and reflective aluminum pigments. It restores and protects metal surfaces from corrosion: roofs, cladding, storage tanks, water ducts, etc. This product can also be used to revitalize aging traditional asphalt roofs.

INTENDED USES:

- Multilayer asphalt roofing
- Metal roofing

CODES:

34005 – 3 L (0.8 gal)
34015 – 18 L (4.8 gal)

BENEFITS

- Extends the service life of existing roofs
- Cures quickly
- Adheres to various materials without primer



BENEFITS

- Allows to reduce surface temperature by protecting it from UV rays
- Restores and protects metal surfaces
- Can be applied on different surfaces, such as asphalt roofing



WATERPROOFING

■ FOUNDATIONS

* LEGEND (codes)

NB: Without box LT: Low temperature

SELF-ADHERED WATERPROOFING MEMBRANE

BASIC WATERPROOFING MEMBRANE

The BASIC WATERPROOFING MEMBRANE is a 1.5 mm self-adhesive membrane made of elastomeric SBS bitumen and trilaminate woven polyethylene. The underface is composed of a silicone film easily detachable. This membrane is mainly used as a base sheet in two-ply roofing systems as well as for the waterproofing of foundations, shower bases, and washrooms.

INTENDED USES:

- Two-ply roofing system
- Foundations
- Showers and washrooms

CODES:

6524201 – 50 cm × 7 m (20" × 23')
65241 – 1 m × 10 m (39" × 33')
15256 – 1 m × 18.6 m (39" × 61')



BENEFITS

- Great tear resistance
- Self-sealing
- Low-temperature grade also offered

WATERPROOFING REPAIR KIT FOR FOUNDATION CRACKS

The WATERPROOFING REPAIR KIT FOR FOUNDATION CRACKS contains all the material needed to repair cracks in the foundations of residential and commercial buildings.

CODE:

61000 – 50 cm × 3.5 m (20" × 11.5')

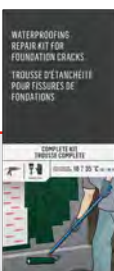

BENEFITS

- Complete kit for repairing and sealing a foundation crack
- Effective and durable
- Easy, mess-free installation

ICF FOUNDATIONS MEMBRANE

The ICF FOUNDATIONS MEMBRANE is a self-adhesive membrane dedicated to the waterproofing of insulated concrete form (ICF) foundations. It is composed of 1 mm thick SBS-modified bitumen and a trilaminate woven polyethylene. The underface is composed of a silicone film easily detachable.

CODES:

10046 – 91 cm × 20.4 m (36" × 67')
10045 – 91 cm × 20.4 m (36" × 67') NB
10049 – 91 cm × 20.4 m (36" × 67') LT
10044 – 91 cm × 20.4 m (36" × 67') LT NB



BENEFITS

- Self-adhesive formulation specially adapted for ICFs
- No primer required on polystyrene surfaces
- Superior adhesion
- Low-temperature grade also offered

FOUNDATIONS COATING

The FOUNDATIONS COATING is a non-fibrous bituminous foundation coating for the protection of foundation walls, footings, retaining walls, wing walls, abutments, and culverts.

CODES:

53060 – 3.78 L (1 gal)
53061 – 18.9 L (5 gal)



BENEFITS

- Ideal to protect masonry or concrete structures and prevent moisture absorption and infiltration
- Easy installation
- Low-temperature grade also offered

BELOW-GRADE DRAINAGE BOARD

The below-grade drainage board is a dimpled high-density polyethylene (HDPE) membrane that keeps foundations and flooring dry. It creates a waterproof vapour barrier and an air space, which allows concrete to breathe while controlling moisture. Our drain board is made from 70% recycled plastic.

CODES:

57106 – 2.44 m × 20 m (8' × 65.6')
57107 – 2.44 m × 20 m (8'(DT) × 65.6')
57105 – 2.21 m × 20 m (7.3' × 65.6')
57104 – 2.07 m × 20 m (6.79' × 65.6')
57103 – 1.98 m × 20 m (6.5' × 65.6')
57102 – 1.83 m × 20 m (6' × 65.6')
57101 – 1.65 m × 20 m (5.5' × 65.6')
57100 – 1.13 m × 15.2 m (3.71' × 50')
24685 – Box of «speedclips» 325 units
24681 – Bag of «speedclips» 65/bag
24683 – Washers 65 units/bag
24682 – Moulding - 10 units
24684 – Plugs 250 units/bag



BENEFITS

- Made of strong, durable HDPE
- Solves problems related to leaks in basements
- Economical

TRANSITION WATERPROOFING MEMBRANE STT MEMBRANE

The STT MEMBRANE is a 1.2 mm self-adhesive membrane composed of elastomeric SBS bitumen and a non-woven polyester exposed reinforcement. The membrane is used as a cover strip over ICF FOUNDATION MEMBRANES top terminations and as an air and moisture barrier for transitions in exterior insulation and finish systems (EIFS) or stucco systems.

CODES:

1204072 – 50 cm × 16.76 m (19.7" × 55')
1204073 – 33 cm × 16.76 m (13" × 55')
1204074 – 25 cm × 16.76 m (9.8" × 55')
1204076 – 15 cm × 16.76 m (5.9" × 55')
1204079 – 11 cm × 16.76 m (4.3" × 55')



BENEFITS

- Extends the service life of foundations
- Easy installation thanks to the self-adhesive coating
- Durable

WATERPROOFING

■ WALLS

AIR AND VAPOR BARRIER MEMBRANE REDZONE PRO

REDZONE PRO is a 1 mm (40 mils) self-adhesive through-wall membrane designed for commercial and residential buildings. It ensures air and water vapor sealing. REDZONE PRO is composed of elastomeric SBS bitumen and a trilaminated woven polyethylene facer. The trilaminated woven polyethylene is compatible with the use of sprayed polyurethane foam insulation.

CODES:
1730009 – 10 cm × 22.9 m (4" × 75')
1730006 – 15 cm × 22.9 m (6" × 75')
1730004 – 23 cm × 22.9 m (9" × 75')
1730003 – 30 cm × 22.9 m (12" × 75')
1730002 – 45 cm × 22.9 m (18" × 75')
14005 – 91 cm × 22.9 m (36" × 75')

BENEFITS

- Self-adhesive: quick, cost-effective and easy installation
- Meets door and window installation standards (CSA A440.4-07)
- Self-sealing around screws and nails



AIR BARRIER AND VAPOR-PERMEABLE MEMBRANE SOPRASEAL STICK VP

Self-adhesive vapour permeable and air barrier membrane with a tri-laminated polypropylene facer used on walls. It can also be used as a through-wall flashing membrane and transition membrane. The self-adhesive underface is covered with a silicone release film.

CODES:
21501 – 0.95 m × 30 m (37" × 98')
21503 – 0.15 m × 30 m (6" × 98')
21504 – 0.23 m × 30 m (9" × 98')
21505 – 0.30 m × 30 m (12" × 98')

BENEFITS

- No primer required
- Better adhesive properties than competitive products
- UV exposure up to 180 days

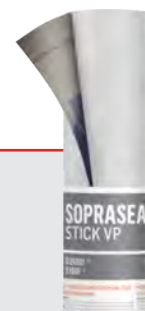

WATERPROOFING

■ DOORS AND WINDOWS

AIR AND VAPOR BARRIER MEMBRANE REDZONE

REDZONE AIR AND VAPOR BARRIER MEMBRANE is a 1 mm (40 mils) self-adhesive membrane composed of elastomeric SBS bitumen and trilaminate woven polyethylene. The underface is composed of a silicone film easily detachable. It seals air and vapour around door and window frames as well as around roof details.

CODES:
17730 – 10 cm × 15 m (4" × 50')
17731 – 15 cm × 15 m (6" × 50')
17732 – 23 cm × 15 m (9" × 50')
17733 – 30 cm × 15 m (12" × 50')
17734 – 46 cm × 15 m (18" × 50')

BENEFITS

- Self-adhesive: quick, cost-effective and easy installation
- Meets door and window installation standards (CSA A440.4-07)
- Self-sealing around screws and nails



REDZONE CORNER GUARD

REDZONE CORNER GUARD is designed to cover and protect the junction between the sill and the jamb, one of the most critical areas.

CODE:
22766 – 6.5 cm × 18.5 cm (2.5" × 7.25")
Box of 50 units

BENEFITS

- Saves time
- Helps reduce costly mistakes caused by intricate cutting, bending, sealing, and caulking



AIR AND VAPOR BARRIER MEMBRANE REDZONE 25

REDZONE 25 AIR AND VAPOR BARRIER MEMBRANE is a 0.6 mm (25 mils) self-adhesive membrane composed of elastomeric SBS bitumen and trilaminate woven polyethylene. The underface is composed of a silicone film easily detachable. It seals air and vapour around door and window frames.

CODES:
17753 – 10 cm × 15 m (4" × 50')
17754 – 15 cm × 15 m (6" × 50')
17755 – 23 cm × 15 m (9" × 50')
17756 – 30 cm × 15 m (12" × 50')
17757 – 46 cm × 15 m (18" × 50')
17752 – 91 cm × 22.9 m (36" × 75')

BENEFITS

- Provides continuous air and vapour barrier
- Meets door and window installation standards (CSA A440.4-07)
- Self-sealing around screws and nails



ALL-WEATHER BUTYL FLASHING TAPE

RESISTO ALL-WEATHER BUTYL FLASHING TAPE is a self-adhesive membrane made of rubberized butyl that blocks air and water infiltration. It is easy to apply to wood, aluminum, polyethylene and PVC surfaces, as well as on air barrier membranes and exterior fibreglass gypsum.

CODES:
22767 – 10 cm × 22.9 m (4" × 75')
22858 – 15 cm × 22.9 m (6" × 75')
22860 – 23 cm × 22.9 m (9" × 75')
22859 – 30 cm × 22.9 m (12" × 75')

BENEFITS

- Superior adhesion at temperatures ranging from -15 to 65 °C (5 to 149 °F) without primer
- Excellent adhesion to most common construction materials, including PVC
- UV resistant for 180 days



WATERPROOFING

■ DECKS AND BALCONIES

JOIST GUARD

Waterproof protection for joists that prevents deterioration of structural timber under exterior floors, such as patios and balconies. The joist guard is a 0.6 mm self-adhesive waterproofing membrane made of elastomeric SBS bitumen and a polyethylene film on the surface. The underface is composed of a silicone film easily detachable. 10 centimeters rolls are ideal for 5 centimeters-wide joists.

CODE:
10099 – 10 cm × 22.9 m (4" × 75')

BENEFITS

- Substantially extends the service life of patios at low cost
- Barely visible between the boards
- Self-sealing around screws and nails



ADJUSTABLE WOOD JOIST SUPPORTS

Set of 10 ADJUSTABLE WOOD JOIST SUPPORTS that are used for deck installation. The supports can be adjusted in height. ADJUSTABLE WOOD JOIST SUPPORTS can be used on ground or roofs to install a patio or plaza deck. They are compatible with wood decking.

CODES:
24218 – SLOPE CORRECTOR
(10 pieces per box)
24221 – ADJUSTABLE SUPPORT
25 to 40 mm (1.0 to 1.6 in)
(10 pieces per box)
24222 – ADJUSTABLE SUPPORT
40 to 60 mm (1.6 to 2.4 in)
(10 pieces per box)
24223 – ADJUSTABLE SUPPORT
60 to 90 mm (2.4 to 3.5 in)
(10 pieces per box)
24219 – ADJUSTABLE SUPPORT
8 to 20 mm (0.3 to 0.8 in)
(10 pieces per box)
24224 – ADJUSTMENT KEY
(Resale as a unit)

BENEFITS

- Protects the waterproofing of the roof
- Durable, reliable and easy to install
- Highly resistant to impact and load



WATERPROOFING

■ WATERPROOFING COMPLEMENTS

MULTIPURPOSE WATERPROOFING MEMBRANE

WHITE LACQUERED FINISH

The MULTIPURPOSE WATERPROOFING MEMBRANE is a 1 mm self-adhesive membrane composed of SBS modified bitumen. This membrane is perfect to waterproof various repair and maintenance works around the house, cottage, or farm.

INTENDED USES:

- Multipurpose

CODES:

66524 – 10 cm × 5 m (4" × 16")
66526 – 15 cm × 5 m (6" × 16")
66529 – 23 cm × 5 m (9" × 16")
66522 – 30 cm × 5 m (12" × 16")
66528 – 46 cm × 5 m (18" × 16")
66520 – 91 cm × 5 m (36" × 16")



BENEFITS

- Low temperature flexibility
- Resistant to outdoor temperature changes

MULTIPURPOSE WATERPROOFING MEMBRANE

ALUMINUM FINISH

The MULTIPURPOSE WATERPROOFING MEMBRANE is a 1 mm self-adhesive membrane composed of SBS modified bitumen. This membrane is perfect to waterproof various repair and maintenance works around the house, cottage, or farm.

INTENDED USES:

- Multipurpose

CODES:

66574 – 10 cm × 5 m (4" × 16")
66576 – 15 cm × 5 m (6" × 16")
66579 – 23 cm × 5 m (9" × 16")
66572 – 30 cm × 5 m (12" × 16")
66578 – 46 cm × 5 m (18" × 16")
66570 – 91 cm × 5 m (36" × 16")



BENEFITS

- Low temperature flexibility
- Resistant to outdoor temperature changes

ROOF REPAIR

ROOF REPAIR is an all-purpose black mastic composed of bitumen, fibres, and mineral fillers, with low level of solvent. Its economic formulation offers good resistance to temperature variations.

CODES:

53003 – 310 ml (10.5 oz)
53004 – 4 kg (8.8 lb)
53006 – 10 kg (22 lb)
53005 – 20 kg (44 lb)



BENEFITS

- Cost-saving solution
- Multipurpose
- Good resistance to temperature variations

SUPER ROOF REPAIR

SUPER ROOF REPAIR is an all-purpose black mastic composed of bitumen, fibres, and mineral fillers, with low level of solvent. Its formulation offers good resistance to temperature variations.

CODES:

53010 – 310 ml (10.5 oz)
53011 – 850 ml (29 oz)
53013 – 1 kg (2.2 lb)
53012 – 4 kg (8.8 lb)
53014 – 10 kg (22 lb)
53015 – 20 kg (44 lb)
53016 – 20 kg (44 lb) LT



BENEFITS

- Can be applied on damp or dry surfaces
- Winter grade also offered
- Good resistance to temperature variations

SUPREME ROOF REPAIR

The SUPREME ROOF REPAIR was specifically developed for professional roofers. With a higher concentration of high-quality bitumen, it seals roof elements such as flashings, vents or upstands, and can also be used to repair various joints, holes and cracks, built-up roofs, etc.

CODES:

53017 – 310 ml (10.5 oz)
53019 – 4 kg (8.8 lb)
53023 – 13.6 kg (30 lb)
53024 – 13.6 kg (30 lb) LT
53022 – 20 kg (44 lb)
53025 – 20 kg (44 lb) LT



BENEFITS

- Designed to adhere to all types of surfaces, either dry or wet
- Winter grade also offered
- The choice of professional roofers

EXTERIOR PRIMER

The EXTERIOR PRIMER is a synthetic polymer-based cold-process compound made of natural resins and solvent. It is used to prime and prepare exterior surfaces, such as concrete, metal, wood and plywood to enhance the adherence of RESISTO elastomeric SBS bitumen self-adhesive membranes.

CODES:
65756 – 350 ml (12.3 oz)
65751 – 910 ml (31 oz)
65755 – 3.78 L (1 gal)
35760 – 10 L (2.6 gal)
65745 – 18.9 L (5 gal)

BENEFITS

- Resistant to water, alcohol and most saline, alkaline and dilute acid solutions
- Primes and prepares several types of surfaces
- Fast curing



EXTERIOR LOW V.O.C. PRIMER

The EXTERIOR LOW V.O.C. PRIMER is a synthetic polymer-based cold-process compound made of natural resins and solvent. It is used to prime and prepare exterior surfaces, such as concrete, metal, wood and plywood to enhance the adherence of RESISTO elastomeric SBS bitumen self-adhesive membranes. It has a very low VOC content and meets LEED requirements (IEQ Credit 4.1).

CODES:
30115 – 350 ml (12.3 oz)
37703 – 3.78 L (1 gal)
37702 – 18.9 L (5 gal)

BENEFITS

- Resistant to water, alcohol and most saline, alkaline and dilute acid solutions
- Primes and prepares several types of surfaces
- Fast curing



FLASHING REINFORCEMENT

Polyester reinforcement used for waterproofing continuity at transition details.

CODE:
32833 – 1.25m² (13.5 ft²)

BENEFITS

- Good resistance to tear and abrasion
- Resistance to moisture and mildew
- Lightweight material



H2O PRIMER

H2O PRIMER is a polymer emulsion-based primer designed to improve the adhesion of RESISTO self-adhesive elastomer SBS modified bitumen waterproofing membranes on most substrates. It is particularly recommended when the use of solvent-based primer is not advised (indoor installation and on polystyrene insulation).

CODES:
30116 – 910 ml (31 oz)
30112 – 3.78 L (1 gal)
30111 – 18.9 L (5 gal)

BENEFITS

- Solvent free
- Compatible with polystyrene insulation



LIQUID WATERPROOFING MEMBRANE ALSAN FLASHING

Patented single-component, polyurethane and bitumen-based waterproofing coating used to waterproof hard-to-access upstands and other details where it is difficult to apply sheet waterproofing membranes.

CODES:
32800 – 19 L (5 gal)
32825 – 3.78 L (1 gal)

BENEFITS

- Superior protection against moisture
- Easy to apply
- Fire hazards are eliminated because no torch is used



ELASTOMERIC SEALANT

ELASTOMERIC SEALER is a mastic containing elastomeric bitumen, volatile solvents, asbestos-free fibres, and mineral fillers to use with RESISTO waterproofing membranes and strips. Can also be used as a caulking mastic and for filling joints and cracks.

CODES:
65650 – 310 ml (10.5 oz)
65655 – 4 kg (8.8 lb)
65653 – 12 kg (26.5 lb)
65700 – 310 ml (10.5 oz) ALUMINIUM

BENEFITS

- Can be applied on wet surfaces
- Adheres to a variety of materials
- Resistant to temperature changes



TO
T
S
C
E
P

INSULATION



INSULATION

REFLECTIVE INSULATION

M2V

M2V is an 8 mm thick reflective insulation consisting of two layers of air bubbles laminated between a metallized polyethylene sheet and a white polyethylene sheet.

INTENDED USES:

- Walls and ceilings
- Water lines and ventilation ducts
- Concrete slabs
- Radiant water heating systems
- Crawl spaces
- Metal frame buildings
- Concrete block walls
- Garage doors
- Water heaters

BENEFITS

- Installs quickly and easily
- Reduces condensation, air infiltration, and energy costs
- Provides an excellent R-value



M2M

M2M is an 8 mm thick reflective insulation consisting of two layers of air bubbles laminated between two metallized polyethylene sheets.

INTENDED USES:

- Walls and ceilings
- Water lines and ventilation ducts
- Radiant water heating systems
- Crawl spaces
- Metal frame buildings
- Concrete block walls
- Garage doors

BENEFITS

- Installs quickly and easily
- Reduces condensation, air infiltration, and energy costs
- Provides an excellent R-value



M1V

M1V is a 4 mm thick reflective insulation consisting of a layer of air bubbles laminated between a metallized polyethylene sheet and a white polyethylene sheet.

INTENDED USES:

- Walls and ceilings
- Water lines and ventilation ducts
- Crawl spaces
- Metal frame buildings
- Concrete block walls
- Garage doors
- Water heaters

BENEFITS

- Installs quickly and easily
- Reduces condensation, air infiltration, and energy costs
- Provides an excellent R-value



CM2P

CM2P is an 8 mm thick reflective insulation consisting of two layers of air bubbles laminated between a metallized polyethylene and a clear polyethylene sheet. The metallized surface is covered with a clear coating that protects the insulation against oxidation in applications under concrete slabs.

INTENDED USES:

- Concrete slabs
- Concrete slabs with integrated radiant heating system

BENEFITS

- Installs quickly and easily
- Reduces condensation, air infiltration, and energy costs
- Provides an excellent R-value



IFLEX

IFLEX is a reflective vapour barrier for walls and ceilings installed between the drywall and insulation to block humidity and protect insulation. The insulating properties of the reflective surface make this a unique product because it increases the R-value of the existing insulation system.

INTENDED USES:

- Walls
- Ceilings

CODE:

55208 – 1.32 m × 31.7 m (52" × 104')

BENEFITS

- Stops moisture to protect insulation
- Keeps the house cooler in the summer



SPACING STRIPS 5 cm

The SPACING STRIPS leave an air gap between the REFLECTIVE INSULATION and the surface to be insulated to achieve maximum insulation simply and economically.

CODE:

55014 – 5 cm × 7,62 m (2" × 25')



ALUMINUM ADHESIVE TAPE

The ALUMINUM ADHESIVE TAPE is composed of a self-adhesive aluminum film and a silicone release film. It is designed to seal the joints of metallic surfaces.

CODES:

20711 – 5 cm × 9.1 m (2" × 30')
20712 – 5 cm × 45.7 m (2" × 150')
20772 – 7.6 cm × 45.7 m (3" × 150')



PRODUCT CODES

REFLECTIVE INSULATION

M2V

55020 – 121.9 cm × 3.8 m (48" × 12.5')
55042 – 121.9 cm × 19 m (48" × 62.5')
55041 – 121.9 cm × 38.1 m (48" × 125')
55050 – 243.8 cm × 19 m (96" × 62.5')
55044 – 243.8 cm × 38.1 m (96" × 125')

CM2P

55145 – 121.9 cm × 38.1 m (48" × 125')
55144 – 243.8 cm × 19 m (96" × 62.5')

M2M

55005 – 40.6 cm × 7.6 m (16" × 25')
55011 – 40.6 cm × 38.1 m (16" × 125')
55015 – 61 cm × 7.6 m (24" × 25')
55002 – 61 cm × 7.6 m (24" × 25')
55108 – 61 cm × 19 m (24" × 62.5')
55087 – 61 cm × 38.1 m (24" × 125')
55018 – 121.9 cm × 3.8 m (48" × 12.5')
55000 – 121.9 cm × 7.6 m (48" × 25')
55049 – 121.9 cm × 19 m (48" × 62.5')
55029 – 121.9 cm × 38.1 m (48" × 125')
55048 – 243.8 cm × 19 m (96" × 62.5')
55035 – 243.8 cm × 38.1 m (96" × 125')

M1V

55021 – 121.9 cm × 3.8 m (48" × 12.5')
55006 – 121.9 cm × 38.1 m (48" × 125')
55054 – 121.9 cm × 19 m (48" × 62.5')
55053 – 243.8 cm × 38.1 m (96" × 125')





MAINTENANCE

MAINTENANCE

■ ASPHALT DRIVEWAYS

ASPHALT DRIVEWAY SEALER 2 YEARS - ASPHALT EMULSION

CODE:
50318 - 17 L (4.5 gal)

An asphalt water-based emulsion coating used to prevent cracks and deterioration of asphalt pavements caused by wear and tear, freezing, oil and gasoline spills, salt, sun and rain.

BENEFITS

- Restores some of the original properties and elasticity of asphalt surfaces
- No unpleasant smell
- Easy and fast application



ASPHALT DRIVEWAY SEALER 4 YEARS - ASPHALT EMULSION

CODE:
50320 - 17 L (4.5 gal)

An asphalt water-based emulsion coating used to prevent cracks and deterioration of asphalt pavements caused by wear and tear, freezing, oil and gasoline spills, salt, sun and rain.

BENEFITS

- Restores some of the original properties and elasticity of asphalt surfaces
- No unpleasant smell
- Easy and fast application



ACRYLIC ASPHALT RESTORER 6 YEARS

CODE:
50049 - 17 L (4.5 gal)

Fast-curing water-based acrylic coating used to prevent cracks and deterioration of asphalt surfaces caused by wear, freezing, oil and gasoline spills, salt, sun, and rain.

BENEFITS

- Provides a very aesthetic deep black finish
- No unpleasant odour
- Simple, quick application using a roller



CLEANER AND DEGREASER

CODE:
50005 - 946 ml (0.25 gal)

Cleaning is a step of the utmost importance to prepare the surface to be protected. The CLEANER AND DEGREASER dissolves and cleans oil stains and grease on asphalt surfaces.

BENEFITS

- Easily dissolves and cleans oil and grease stains



OIL SPOT PRIMER

The OIL SPOT PRIMER is a polymer emulsion that enhances the adhesive strength of asphalt driveway sealers on asphalt surfaces affected by oil spills.

CODE:
50004 – 946 ml (0.25 gal)

BENEFITS

- Optimizes adhesive strength of asphalt driveway sealers



LIQUID CRACK FILLER

The LIQUID CRACK FILLER is designed to repair small cracks and joints into asphalt surfaces. For cracks up to 6 mm (1/4 in) in width.

CODES:
50012 – 946 ml (0.25 gal)
50006 – 3.78 L (1 gal)

BENEFITS

- Strongly adheres to the walls of the cracks
- Remains flexible
- Highly resistant to temperature variations



LEVELLING PATCH

The LEVELLING PATCH is designed to repair medium cracks and joints in asphalt pavement and to level shallow depressions in asphalt surfaces. It prevents damage to asphalt surfaces caused by wear, rain, and frost. For cracks up to 20 mm (3/4 in) in width.

CODES:
50007 – 3.62 kg (8 lb)
50008 – 13.6 kg (30 lb)

BENEFITS

- Efficiently levels the cracks, joints and slight depressions on asphalt surfaces for a more beautiful look
- Extends the service life of asphalt surfaces



ASPHALT REPAIR

The ASPHALT REPAIR is composed of a ready-to-use mixture of adherent aggregates. It forms a solid bond with all firm surfaces, whether wet or dry. For the repair of holes and cracks of 20 mm (3/4 in) and more.

CODES:
26301 – 10 kg (22 lb)
20628 – 20 kg (44 lb)

BENEFITS

- Can be installed at any temperature



RUBBERIZED CRACK FILLER

The RUBBERIZED CRACK FILLER for asphalt surfaces is designed to repair cracks, joints, and other damage to asphalt surfaces. It prevents damage to asphalt surfaces caused by wear, rain, and frost. For cracks up to 1 cm (3/8 in) in width.

CODE:
50003 – 300 ml (10 oz)

BENEFITS

- Strongly adheres to the walls of the cracks
- Remains flexible
- Highly resistant to temperature variations





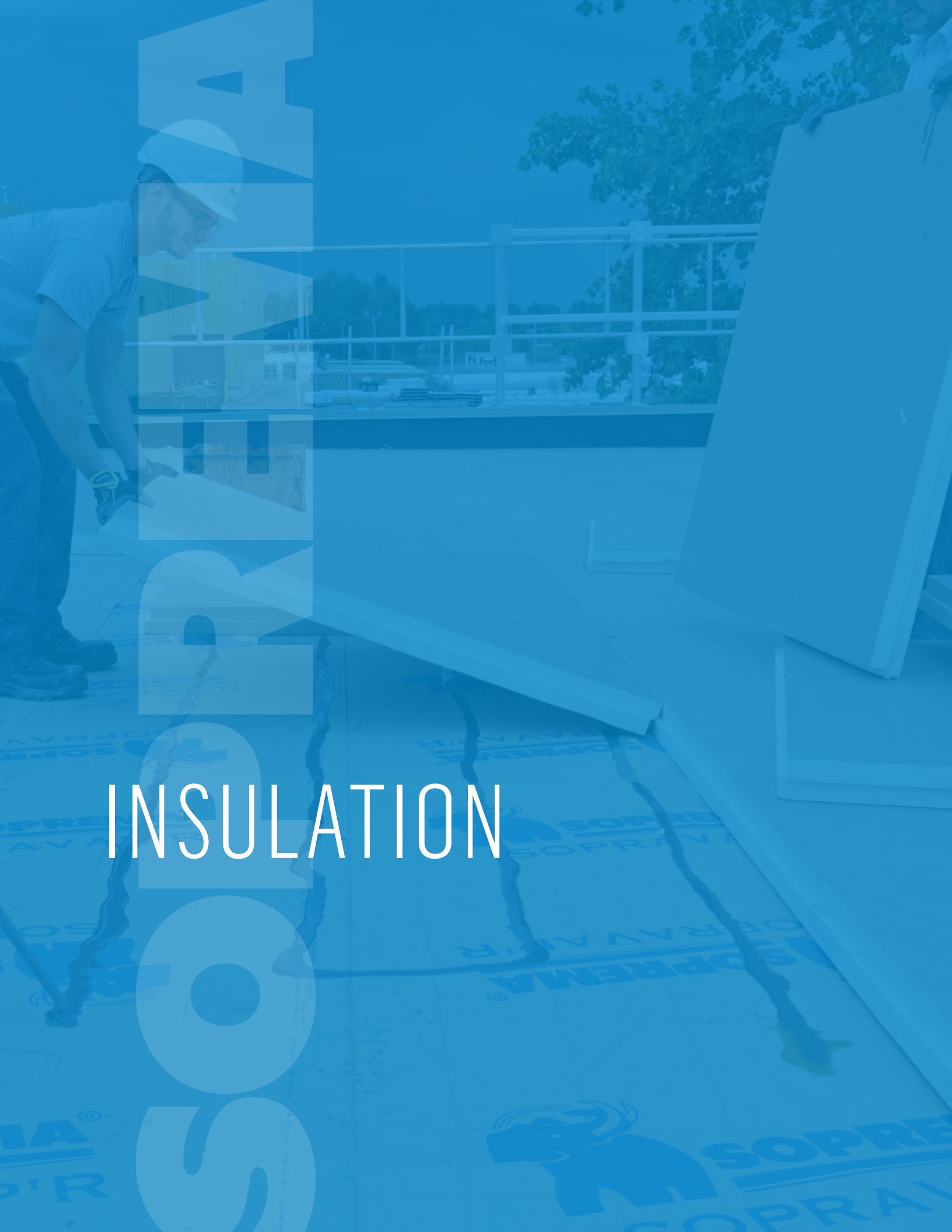

INSULATION

INSULATION

■ EXTRUDED POLYSTYRENE

SOPRA-XPS 20

SOPRA-XPS 20 is a rigid thermal insulation board made of extruded polystyrene composed of closed cell foam. SOPRA-XPS 20 is mainly used as thermal insulation for above grade SOPREMA wall systems and on the inside of foundation walls. It can also be used for residential applications on exterior foundation walls and under concrete slabs. Compliant with CAN/ULC S701.1, Type 3.

INTENDED USES:

- Walls

BENEFITS

- Exceptional resistance to water and humidity
- Durable and strong
- Superior initial and long-term thermal performance (R-5/in)



SOPRA-XPS 30

SOPRA-XPS 30 is a rigid thermal insulation board made of extruded polystyrene with shiplap or square edges on its four sides. It is composed of closed cell foam. It is mainly used as a thermal insulation for SOPREMA foundation wall systems and under concrete slabs where the applied loads do not exceed 30 psi. Compliant with CAN/ULC-S701.1 Type 4.

INTENDED USES:

- Foundation walls,
under concrete slabs

BENEFITS

- Exceptional resistance to water and humidity
- Durable and strong
- Superior initial and long-term thermal performance (R-5/in)



SOPRA-XPS 25 CW

SOPRA-XPS 25 CW is a rigid thermal insulation board made of extruded polystyrene composed of closed cell foam. SOPRA-XPS 25 CW is mainly used as a thermal insulation for above grade SOPREMA wall systems. SOPRA-XPS 25 CW insulation boards are scored squared every 400 mm (16 in) and 600 mm (24 in) so they can easily be cut when they need to fit perfectly between wall ties. Compliant with CAN/ULC S701.1 Type 3.

INTENDED USES:

- Cavity walls

BENEFITS

- Exceptional resistance to water and humidity
- Durable and strong
- Superior initial and long-term thermal performance (R-5/in)



SOPRA-XPS 35

SOPRA-XPS 35 is a rigid thermal insulation board made of extruded polystyrene composed of closed cell foam. SOPRA-XPS 35 is available with shiplap edges on all four sides in several thickness and square edges in the thickness of 25 mm (1 in). It is mainly used as a thermal insulation for SOPREMA protected-membrane roofing systems (inverted roofs). Compliant with CAN/ULC S701.1, Type 4.

INTENDED USES:

- Inverted roofing

BENEFITS

- Exceptional resistance to water and humidity
- Durable and strong
- Superior initial and long-term thermal performance (R-5/in)



SOPRA-XPS 40

SOPRA-XPS 40 is a rigid thermal insulation board made of high-density extruded polystyrene with squared edges on its four sides. It is composed of closed cell foam. SOPRA-XPS 40 is designed for applications requiring high-density insulation on which heavy loads will be applied. It is mainly used for SOPREMA foundation systems under slabs, protected-membrane roofing systems (inverted), parking decks, and plaza decks. Compliant with CAN/ULC S701.1, Type 4.

INTENDED USES:

- Foundation systems
- Inverted roofing
- Civil engineering



BENEFITS

- Exceptional resistance to water and humidity
- Durable and strong
- Superior initial and long-term thermal performance (R-5/in)

SOPRA-XPS 60

SOPRA-XPS 60 is a rigid thermal insulation board made of high-density extruded polystyrene with squared edges on its four sides. It is composed of closed cell foam. SOPRA-XPS 60 is designed for applications requiring high-density insulation on which heavy loads will be applied. It is mainly used for SOPREMA foundation systems under slabs, protected-membrane roofing systems (inverted), parking decks, and plaza decks. Compliant with CAN/ULC S701.1, Type 4.

INTENDED USES:

- Foundation systems
- Inverted roofing
- Civil engineering



BENEFITS

- Exceptional resistance to water and humidity
- Durable and strong
- Superior initial and long-term thermal performance (R-5/in)

SOPRA-XPS 100

SOPRA-XPS 100 is a rigid thermal insulation board made of high-density extruded polystyrene with squared edges on its four sides. It is composed of closed cell foam. SOPRA-XPS 100 is designed for applications requiring high-density insulation on which heavy loads will be applied. It is mainly used for SOPREMA foundation systems under slabs, protected-membrane roofing systems (inverted), parking decks, and plaza decks. Compliant with CAN/ULC S701.1, Type 4.

INTENDED USES:

- Foundation systems
- Inverted roofing
- Civil engineering



BENEFITS

- Exceptional resistance to water and humidity
- Durable and strong
- Superior initial and long-term thermal performance (R-5/in)

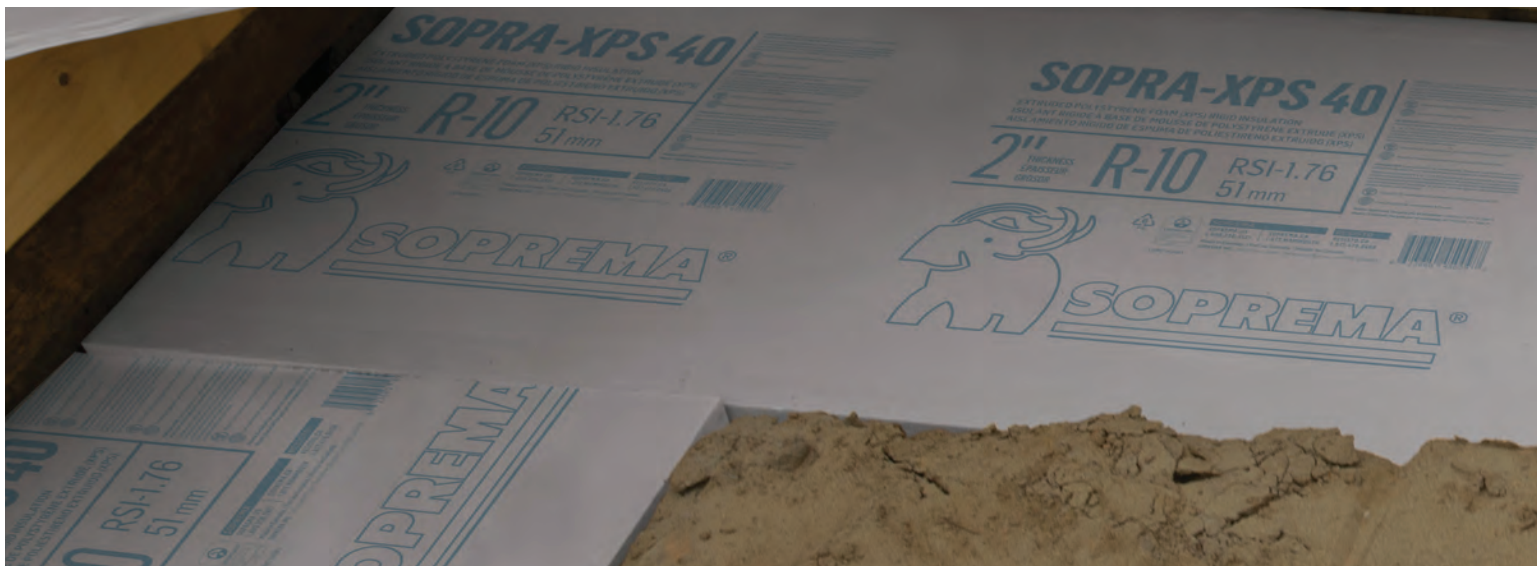

PRODUCT CODES

EXTRUDED POLYSTYRENE

SOPRA-XPS 20

44322 – SOPRA-XPS 20 with shiplap edges (length) – 8' × 4' × 1"
 44323 – SOPRA-XPS 20 with shiplap edges (length) – 8' × 4' × 1.5"
 44324 – SOPRA-XPS 20 with shiplap edges (length) – 8' × 4' × 2"
 44325 – SOPRA-XPS 20 with shiplap edges (length) – 8' × 4' × 3"
 44326 – SOPRA-XPS 20 with shiplap edges (length) – 8' × 4' × 4"
 44327 – SOPRA-XPS 20 with shiplap edges (length) – 9' × 4' × 1"
 44328 – SOPRA-XPS 20 with shiplap edges (length) – 9' × 4' × 1.5"
 44431 – SOPRA-XPS 20 with slotted edges (length) – 8' × 2' × 2"
 44365 – SOPRA-XPS 20 with shiplap edges (length) – 9' × 4' × 2"
 44366 – SOPRA-XPS 20 with shiplap edges – 8' × 2' × 1"
 44367 – SOPRA-XPS 20 with shiplap edges – 8' × 2' × 1.5"
 44368 – SOPRA-XPS 20 with shiplap edges – 8' × 2' × 3"
 44414 – SOPRA-XPS 20 with straight edges – 8' × 2' × 2"
 44415 – SOPRA-XPS 20 with shiplap edges – 8' × 4' × 1"
 44416 – SOPRA-XPS 20 with shiplap edges – 8' × 4' × 1.5"
 44417 – SOPRA-XPS 20 with shiplap edges – 8' × 4' × 2"
 44418 – SOPRA-XPS 20 with straight edges – 8' × 2' × 1"
 44419 – SOPRA-XPS 20 with straight edges – 8' × 2' × 1.5"
 44420 – SOPRA-XPS 20 with straight edges – 8' × 2' × 3"
 44429 – SOPRA-XPS 20 with shiplap edges – 8' × 2' × 2"
 44430 – SOPRA-XPS 20 with slotted edges (length) – 8' × 2' × 1.5"

SOPRA-XPS 30

44372 – SOPRA-XPS 30 with shiplap edges – 8' × 2' × 1"
 44373 – SOPRA-XPS 30 with shiplap edges – 8' × 2' × 4"
 44374 – SOPRA-XPS 30 with straight edges – 8' × 2' × 1.5"
 44434 – SOPRA-XPS 30 with shiplap edges – 8' × 2' × 2.5"
 44435 – SOPRA-XPS 30 with straight edges – 8' × 2' × 1"
 44436 – SOPRA-XPS 30 with straight edges – 8' × 2' × 4"
 45000 – SOPRA-XPS 30 with shiplap edges – 8' × 2' × 1.5"
 45001 – SOPRA-XPS 30 with shiplap edges – 8' × 2' × 2"
 45002 – SOPRA-XPS 30 with shiplap edges – 8' × 2' × 3"
 45003 – SOPRA-XPS 30 with straight edges – 8' × 2' × 2"
 45004 – SOPRA-XPS 30 with straight edges – 8' × 2' × 3"

SOPRA-XPS 35

44375 – SOPRA-XPS 35 with straight edges – 8' × 2' × 1"
 44376 – SOPRA-XPS 35 with shiplap edges – 8' × 2' × 2.5"
 44377 – SOPRA-XPS 35 with shiplap edges – 8' × 2' × 3.5"
 45005 – SOPRA-XPS 35 with shiplap edges – 8' × 2' × 2"
 45006 – SOPRA-XPS 35 with shiplap edges – 8' × 2' × 1.5"
 45007 – SOPRA-XPS 35 with shiplap edges – 8' × 2' × 3"
 45008 – SOPRA-XPS 35 with shiplap edges – 8' × 2' × 4"

SOPRA-XPS 40

44483 – SOPRA-XPS 40 with straight edges – 8' × 2' × 1"
 44484 – SOPRA-XPS 40 with straight edges – 8' × 2' × 1.5"
 44485 – SOPRA-XPS 40 with straight edges – 8' × 2' × 2.5"
 44486 – SOPRA-XPS 40 with straight edges – 8' × 2' × 3.5"
 45009 – SOPRA-XPS 40 with straight edges – 8' × 2' × 2"
 45010 – SOPRA-XPS 40 with straight edges – 8' × 2' × 3"

SOPRA-XPS 60

44360 – SOPRA-XPS 60 with straight edges – 8' × 2' × 2.5"
 44361 – SOPRA-XPS 60 with straight edges – 8' × 2' × 3.5"
 44438 – SOPRA-XPS 60 with straight edges – 8' × 2' × 1"
 44439 – SOPRA-XPS 60 with straight edges – 8' × 2' × 1.5"
 45011 – SOPRA-XPS 60 with straight edges – 8' × 2' × 2"
 45012 – SOPRA-XPS 60 with straight edges – 8' × 2' × 3"

SOPRA-XPS 100

44362 – SOPRA-XPS 100 with straight edges – 8' × 2' × 2"
 44363 – SOPRA-XPS 100 with straight edges – 8' × 2' × 3"

SOPRA-XPS 25 CW

44369 – SOPRA-XPS 25 CW with straight edges – 2 400 mm × 1 200 mm × 50 mm
 44370 – SOPRA-XPS 25 CW with straight edges – 2 400 mm × 1 200 mm × 75 mm
 44371 – SOPRA-XPS 25 CW with straight edges – 2 400 mm × 1 200 mm × 100 mm
 44432 – SOPRA-XPS 25 CW with straight edges – 2 400 mm × 1 200 mm × 40 mm
 44433 – SOPRA-XPS 25 CW with straight edges – 2 400 mm × 1 200 mm × 61 mm

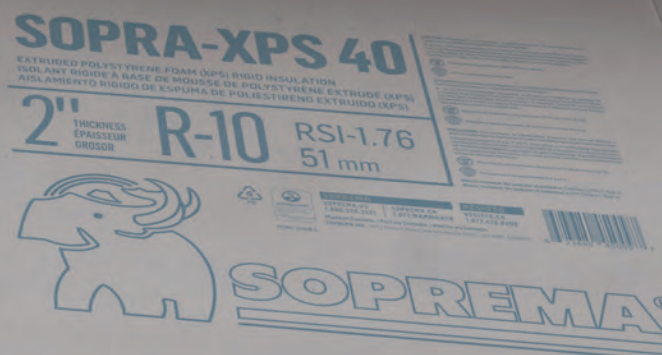

INSULATION

■ POLYISOCYANURATE

SOPRA-ISO

SOPRA-ISO is a polyisocyanurate insulation board with a closed-cell structure with a fibreglass-reinforced organic coating. Since their R-value is the highest among all types of roof insulation (R-5.7), the result is a thinner yet more efficient roof system. The high dimensional stability of polyisocyanurate prevents the creation of thermal bridges in the roof system.

INTENDED USES:

- Roofing

BENEFITS

- Highest thermal resistance among all types of roof insulation
- Excellent dimensional stability
- Available with straight or shiplap edges for an installation that is twice as fast



SOPRA-ISO PLUS

SOPRA-ISO PLUS is a polyisocyanurate insulation board with a closed-cell structure with a polymer-covered fibreglass coating. Since their R-value is the highest among all types of roof insulation (R-5.7), the result is a thinner yet more efficient roof system. The high dimensional stability of polyisocyanurate prevents the creation of thermal bridges in the roof system.

INTENDED USES:

- Roofing

BENEFITS

- Increased dimensional stability due to fibreglass coating
- Mould resistant



SOPRA-ISO V PLUS

SOPRA-ISO V PLUS is a polyisocyanurate insulation board with a closed-cell structure coated on both sides with non-reflecting fibreglass.

INTENDED USES:

- Walls

BENEFITS

- R-value per inch greater than other types of insulation (R-6/in)
- Durable and lightweight
- Compatible with most solvents used in construction adhesives



SOPRA-ISO V ALU

SOPRA-ISO V ALU is a closed-cell structure polyisocyanurate insulation board with an underface coated with an aluminum reflective layer promoting radiation and a surface coated with an aluminum layer covered with an antireflective acrylic film.

INTENDED USES:

- Walls

BENEFITS

- R-value per inch greater than other types of insulation (R-6.5/in)
- Durable and lightweight
- Compatible with most solvents used in construction adhesives



PRODUCT CODES

POLYISOCYANURATE

SOPRA-ISO

40400 - 4' x 4' x 1"	40465 - 8' x 4' x 1"
40405 - 4' x 4' x 1.5"	40438 - 8' x 4' x 1.5"
40410 - 4' x 4' x 2"	40421 - 8' x 4' x 2"
40415 - 4' x 4' x 2.5"	40423 - 8' x 4' x 2.5"
40436 - 4' x 4' x 3"	40453 - 8' x 4' x 3"
40433 - 4' x 4' x 3.5"	40521 - 8' x 4' x 3.5"
40431 - 4' x 4' x 4"	40474 - 8' x 4' x 4"
40288 - 4' x 4' x 4.5"	40306 - 8' x 4' x 4.5"
41457 - 4' x 4' x 5"	41458 - 8' x 4' x 5"
41461 - 4' x 4' x 5.5"	41462 - 8' x 4' x 5.5"
41387 - 4' x 4' x 6"	41388 - 8' x 4' x 6"

SOPRA-ISO PLUS

40418 - 4' x 4' x 1"	40643 - 8' x 4' x 1"
40419 - 4' x 4' x 1.5"	40398 - 8' x 4' x 1.5"
40420 - 4' x 4' x 2"	40541 - 8' x 4' x 2"
40452 - 4' x 4' x 2.5"	40399 - 8' x 4' x 2.5"
40426 - 4' x 4' x 3"	40397 - 8' x 4' x 3"
40802 - 4' x 4' x 3.5"	40311 - 8' x 4' x 3.5"
40889 - 4' x 4' x 4"	41329 - 8' x 4' x 4"
41059 - 4' x 4' x 4.5"	41542 - 8' x 4' x 4.5"
41545 - 4' x 4' x 5"	41546 - 8' x 4' x 5"
41553 - 4' x 4' x 6"	41554 - 8' x 4' x 6"

SOPRA-ISO V ALU

44340 - 8' x 4' x 0.5"	44336 - 8' x 4' x 2.5"
44357 - 8' x 4' x 0.75"	44347 - 8' x 4' x 3"
44339 - 8' x 4' x 1"	44332 - 8' x 4' x 3.5"
44338 - 8' x 4' x 1.5"	44333 - 8' x 4' x 4"
44337 - 8' x 4' x 2"	

SOPRA-ISO V PLUS

44342 - 8' x 4' x 0.5"	44346 - 8' x 4' x 2.5"
44381 - 8' x 4' x 0.75"	44341 - 8' x 4' x 3"
44343 - 8' x 4' x 1"	44334 - 8' x 4' x 3.5"
44344 - 8' x 4' x 1.5"	44335 - 8' x 4' x 4"
44345 - 8' x 4' x 2"	



INSULATION

■ CELLULOSE

SOPRA-CELLULOSE

SOPRA-CELLULOSE insulation is made of 85% post-consumer recycled newspapers. It acts as a protective shield to reduce the transmission of heat and noise. Efficient and environmentally friendly, SOPRA-CELLULOSE will reduce energy consumption and improve comfort in a wide range of climatic conditions.

INTENDED USES:

- Floors
- Attic
- Interior and exterior walls

CODE: 1000-111



BENEFITS

- High thermal resistance (R-3.7/in)
- Fire resistance and superior acoustic properties
- CAN/ULC-S703 compliant product with superior resistance to corrosion, mould and insects

SOPRA-CELLULOSE VENT

SOPRA-CELLULOSE VENT is a pre-folded rigid cardboard piece perforated along folding lines used to prevent the overflow of SOPRA-CELLULOSE cellulosic fibre on the roof overhang during and after installation. It also maximizes the R-value at the edges of the building and allows good ventilation in the attic. SOPRA-CELLULOSE VENT must be installed with SOPRA-CELLULOSE insulation in ventilated roofs. SOPRA-CELLULOSE VENT XL is longer than the standard version to meet the new attic insulation requirements of provincial and national regulations (up to R-61 or RSI-10.8).

CODES:
1000-228 – 101,6 cm × 64,14 cm (40" × 25.25")
1000-226 – 70 cm × 63.7 cm (27.56" × 25.06")



SOPRA-CELLULOSE RULER

SOPRA-CELLULOSE RULER is used to control and verify the thickness of SOPRA-CELLULOSE insulation in attics. It indicates the thickness to be applied in accordance with the thermal resistance of the insulation up to 60 for R-value and 10.8 for RSI.



SOPRA-CELLULOSE MACHINE

Used to insulate attics with cellulose, the SOPRA-CELLULOSE MACHINE is lightweight and easy to transport in two pieces.

It is easy to use with a wireless remote control and offers high efficiency.







SOUNDPROOFING

SOUNDPROOFING

INSONOFLOOR

INSONOFLOOR is a high-density elastomeric SBS-modified bitumen and polyethylene membrane coated with small granules of recycled rubber. It is specially designed to soundproof laminated floating floors and other types of flooring, such as hardwood or multilayer engineered wood.

CODE:
10414 – 89 cm × 12 m (35" × 39")

BENEFITS

- Superior acoustic performances
- Rotproof
- Adjusts well to the media, resists tearing, and cuts moisture



INSONOMAT

INSONOMAT is an acoustic membrane made from elastomeric bitumen and recycled rubber specially developed for use under a 38 mm (1 1/2 in) thick concrete covering.

CODE:
10413 – 91 cm × 6 m (36" × 19.7")

BENEFITS

- Contributes to the waterproofing of the structure at the time of concrete casting
- Prevents the water in concrete to evaporate too quickly to increase its quality
- Can be installed and sealed easily with easy-to-use self-adhesive tape

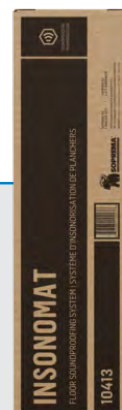

SOPRAWAY NG2

SOPRAWAY NG2 membrane allows the direct application of polymer-modified mortar for any type of tiling. Made of 100% recycled rubber, the SOPRAWAY NG2 membrane can block the spread of cracks in concrete slabs and offers excellent acoustic performance.

CODE:
26132 – 91 cm × 7.6 m (36" × 25')

BENEFITS

- Reduces impact noise and airborne noise
- 100% recycled content
- Designed according to the LEED® philosophy



SOPRAWAY ADHESIVE

SOPRAWAY adhesive is a homogeneous solvent free, low odour, acrylic latex emulsion based adhesive. SOPRAWAY adhesive is used for interior installation of SOPRAWAY NG2 rubber acoustic membrane.

CODE:
21954 – 19 L (5 gal)

BENEFITS

- Solvent free and low odour
- Easy trowel applied



INSONO AF3-47 / 90 / 130

INSONO AF3 self-adhesive membranes are composed of polymer-modified bitumen and an exposed non-woven polyester reinforcement. The self-adhesive underface of the membrane is protected by a silicone release film to allow quick and easy installation.

CODES:
00572 – INSONO AF3-130
91 cm × 8 m (36" × 26")
00328 – INSONO AF3-90
91 cm × 15 m (36" × 49")
12050 – INSONO AF3-47
1 m × 16.76 m (39" × 55")

BENEFITS

- Non-woven polyester reinforcement on the surface allowing direct application and optimum adhesion of a polymer-modified mortar
- Compatible with many types of substrates such as concrete and plywood
- Resists traffic



INSONO AF3 ADHESIVE

INSONO AF3 adhesive is a homogeneous solvent free, low odour, acrylic latex emulsion based adhesive. It is used for interior installation of INSONO AF3 acoustic membrane.

CODE:
24954 – 19 L (5 gal)

BENEFITS

- Solvent free and low odour
- Used for interior installation of INSONO AF3 acoustic membrane.



ACOUSTIZOL NG

ACOUSTIZOL NG is an acoustic membrane made of polyester fibres laminated on an aluminized polyethylene film. It is used in wall and ceiling assemblies.

CODE:
40373 – 1.2 m × 7.6 m (48" × 25')

BENEFITS

- Increased reduction of airborne noise
- Easy and fast to install
- Hypoallergenic, prevents itching problems



ACOUSTIVIBE

ACOUSTIVIBE insulators and furrings ensure soundproofing of gypsum ceilings in a unique and innovative way. Instead of directly fastening furrings on the girders or joists, they are suspended with fasteners supplied with a piece of rubber. They absorb shocks and vibrations from the upper floor and prevent their transmission through the ceilings. In this way, the room is isolated from noises caused by footsteps, vacuuming, children playing, etc.

CODES:
21253 – Insulator (100 units)
21254 – 3.65 m (12") Furrings (10 units)

BENEFITS

- Easy and fast to install
- No specialized tools required
- Increased acoustic performance exceeding requirements

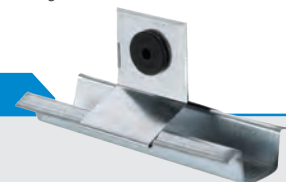

ACOUSTIVIBE WDC

ACOUSTIVIBE WDC anchors are used on structures other than wooden beams or joists. They are used to separate the suspended ceiling from the structure to which it is attached. Hence, they play a vital role in achieving an effective acoustic performance.

CODE:
21727 – 100 units

BENEFITS

- Easy to install
- Resistant
- Elimination of vibration transfer



ACOUSTIVIBE CDC

ACOUSTIVIBE CDC anchors are used on structures made of concrete structural slab, steel with concrete, of Hambro® type or any structures other than wood with concrete on which the ceiling is suspended. They are used to separate the suspended ceiling from the structure to which it is attached. Hence, they play a vital role in achieving an effective acoustic performance.

CODE:
21723 – 100 units

BENEFITS

- Easy to install
- Resistant
- Elimination of vibration transfer

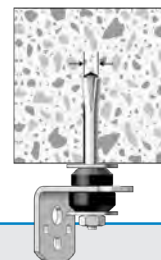

ACOUSTIDRAIN

ACOUSTIDRAIN is a revolutionary acoustic product that eliminates noise caused by water flowing through sanitary drainage or storm drain piping. ACOUSTIDRAIN is self-adhesive and also has a self-adhesive closure.

CODES:

09982 – ACOUSTIDRAIN (5)
99 cm × 40 cm (39 in × 15.75 in)
09983 – Extension kit (5)
7.5 cm × 99 cm (3" × 39")
09984 – ACOUSTIDRAIN ELBOW (2)
32.4 cm × 49.5 cm (12.75" × 19.5")

BENEFITS

- Easy and fast to install
- No specialized tools required
- Supplied with a kit that includes everything needed to soundproof the pipes and elbows

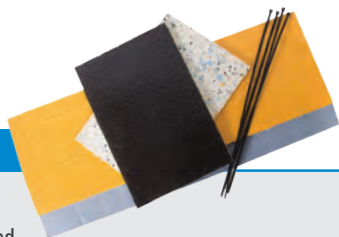

ACOUSTIBOARD

The ACOUSTIBOARD panel is a revolutionary acoustical product that eliminates the need for the 38 mm (1 1/2 in) concrete covering that is usually poured over wood frames, while providing excellent acoustic performance. This means that installation is easier, quicker and cheaper.

CODES:

08018 – 91 cm × 1.22 m (36" × 48")
0801810 – 8.9 cm × 1.22 m (3.5" × 48")
0801807 – 12.7 cm × 1.22 m (5" × 48")
0801804 – 22.9 cm × 1.22 m (9" × 48")

BENEFITS

- Ideal for new buildings and renovations
- Easy and fast to install
- No specialized tools required

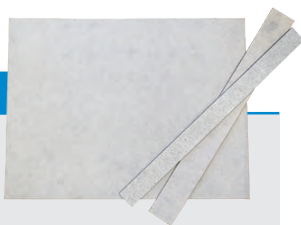

TECSOUND CLG 5900

One-component, acrylic sealant used to fill the unseen gaps and joints where the wall meets the floor or ceiling. The TECSOUND CLG 5900 sealant is the first step before the installation of TECSOUND CLG 3900 noiseproofing compound. For interior use.

CODE :

24770 – 828 ml (28 oz.)

BENEFITS

- Seals the cracks and gaps to prevent unwanted noise from escaping or entering a room
- Ideal for new construction or remodeling projects
- Fast, simple and accessible due to its low technical requirements



VELAPHONE

VELAPHONE is an acoustic membrane made of polyester felt and a black vapour barrier film. It is specially designed to be installed primarily on wood structures under self-levelling concrete coverings of 38 mm (1 1/2 in) in thickness.

CODE:

22722 – 1 m × 20 m (39" × 65")

BENEFITS

- Contributes to the waterproofing of the structure at the time of concrete casting
- Prevents the water in concrete to evaporate too quickly to increase its quality
- Resists crushing over time to better retain its acoustic properties



TECSOUND CLG 3900

Single-component acrylic compound used as a soundproofing material for walls and ceilings. TECSOUND CLG 3900 acts as a decoupling material using mass-spring-mass principle by changing the vibration frequency of the assembly, reducing the transmission of airborne noise (ASTM E90) and impact noise (ASTM E492).

CODE :

24514 – 828 ml (28 oz.)

BENEFITS

- Ideal for home remodeling projects
- Solvent-free
- Fast, simple and accessible due to its low technical requirements



TECSOUND ACOUSTIC BAFFLE

Melamine foam panel used for noise absorption and acoustic correction of various types of spaces (offices, businesses, etc.). The TECSOUND ACOUSTIC BAFFLE panel provides excellent acoustic properties because of its open-cell structure. The panels also integrate well with other interior components.

CODE :

24314 – 1200 mm × 600 mm (47.25" × 23.63")

BENEFITS

- Excellent product designed to absorb noises and attenuate reverberations to reduce echo
- Very light, fibre-free and easy-to-install product
- An aesthetic and acoustic product that integrates well with the interior design



A blue-tinted photograph of a child's hands playing with a ball of yarn. The child's hands are visible in the upper right corner, holding the yarn. The yarn is a light color with small dark dots. The background is a blurred wooden surface.

ALSAN

ALSAN

FOAMS AND SEALANTS

ALSAN FLEX 2945 SB

Alsan Flex 2945 SB is a high performance sealant and adhesive among others due to its superior adhesive properties. Alsan Flex 2945 SB is solvent and isocyanate free which makes it a safe product for installers, building occupants and the environment. With its powerful adhesive strength, this sealant can be applied on dry or wet surfaces. Moisture cure, no shrinkage, UV resistant, 100% waterproof and paintable, this product is an ally for all jobs.

CODES:
24716 – 300 ml (10.1 oz) WHITE
24717 – 300 ml (10.1 oz) BLACK
24718 – 300 ml (10.1 oz) GREY



BENEFITS

- ± 35% joint movement
- For dry or wet surfaces
- Solvent and isocyanate-free

ALSAN FOAM EPS/XPS

Alsan Foam EPS/XPS adhesive will save you time and money when installing polystyrene and polyurethane insulation boards. This low-expansion one-component polyurethane adhesive foam is specially designed to bond all types of polystyrene and polyurethane insulation materials to most construction materials. Compatible with polystyrene and urethane foams, including SOPRA-XPS and SOPRA-ISO.

CODE:
24720 – 750 ml (30 oz)



BENEFITS

- High yield formulation - Cover up to 150 square feet (14 m²)
- Quick installation - less cartridge change
- High grab, Holding power within 2 hours

ALSAN FOAM UNI W PRO

Alsan Foam UNI W insulation foam is the perfect ally for airtightness around doors and windows in the most varied climates. One-component, low-expansion polyurethane foam specifically formulated for use in the widest range of climates and temperatures on windows, doors, gaps and cracks. Exterior and interior uses. Formulated to air seal gaps around rough openings of windows and doors.

CODE:
24721 – 850 ml (Gw. 1000g/35 oz.)



BENEFITS

- Insulates and seals
- Won't bow window and doors frames
- Application in a wide temperature range: -25°C to 30°C (-13°F to 86°F)

ALSAN FOAM UNI W

Alsan Foam UNI W insulation foam is the perfect ally for airtightness around doors and windows in the most varied climates. This low-expansion, one-component polyurethane foam is formulated to air seal gaps around rough openings, save energy and provide permanent adhesion to vinyl, wood and metal, in addition to being airtight and water-resistant.

CODE:
24722 – 500 ml (Gw. 570g/20 oz.)



BENEFITS

- Insulates and seals
- Won't bow window & doors frames
- Application in a wide temperature range: -20°C to 30°C (-4°F to 86°F)

ALSAN FOAM CL-F

Powerful multipurpose aerosol cleaner for removing uncured or fresh polyurethane foam. Formulated to clean foam dispensing guns, tools, and work surfaces.

CODE:
24723 – 500 ml (16.4 oz)

BENEFITS

- Ready-to-use cleaning agent
- Powerful cleaner to remove uncure foam
- Fits directly on PU foam gun or used separately as a handheld aerosol can



ALSAN FOAM GUN FG-ST5

CODE: 24724

The dispensing gun Foam Gun FG-ST5 allows for precision application and easy bead control. It makes it easier to reach tight spaces.

BENEFITS

- Anti-stick coated for easy-cleaning
- Premium reusable tool
- 19 cm (7.5 in.) barrel







POLYMER INNOVATION

CHEM LINK

High-performance
adhesives, sealants and coatings



M-1

M-1 is both an adhesive and a sealant. It adheres to a wide range of building materials such as PVC, EPDM, most metals, wood, glass, masonry concrete, fibreglass, and solvent-sensitive foams. It can also be used as a structural adhesive.

CODES:

F1277 – 150 ml (5 oz) (36/pack)
F1209 – 300 ml (10.1 oz) (16/pack)
F1270 – 300 ml (10.1 oz) (24/pack)
F1204 – 825 ml (28 oz) (12/pack)
F1190 – 600 ml (20 oz) (12/pack)
F1205 – 7.6 L (2 gal)
F1206 – 19 L (5 gal)

Colours available:

White (WH) Gray (GR) Black (BL)
Tan (TN) Dark Bronze (DB) Limestone (LI)

BENEFITS

- Does not contract
- No solvents, nontoxic, odourless, and safe for human health
- Can be applied up to 0 °C (32 °F)



DURALINK 35

DuraLink 35 sealant creates a durable, highly elastic seal that forms a film in less than 40 minutes in a humid environment. It is designed to be applied to residential cladding, architectural metal, curtain wall constructions, and joints subject to movements. It adapts to joint movements of +/- 35%.

CODE:

F1263 – 300 ml (10.1 oz) (24/pack)

Colours available:

White (WH) Gray (GR) Forest Green (FG) Limestone (LI)
Tan (TN) Dark Bronze (DB) Stone (ST) Aluminum (AG)
Medium Bronze (MB) Almond (AL) Terra Cotta (TR) Redwood Tan (RT)
Weathered Wood (WW)

BENEFITS

- Adheres to a variety of common construction materials
- Cures quickly
- Comes in a wide range of colours



NOVALINK 35

NovaLink 35 is a sealant for concrete joints and masonry elements that does not sag. It is designed to be used on wet or dry concrete. It adapts to joint movements of +/- 35%.

CODES:

F1240 – 300 ml (10.1 oz) (24/pack)
F1253 – 600 ml (20 oz) (12/pack)

Colours available:

White (WH) Gray (GR) Black (BL) Limestone (LI)
Tan (TN) Dark Bronze (DB) Stone (ST) Ivory (IV)
Aluminum (AG) Medium Bronze (MB) Almond (AL) Terra Cotta (TR)
Redwood Tan (RT) Buff (BU) Natural Clay (NC) Anodized Aluminum (AA)
Aluminum Stone (AS) Beige (BE) Charcoal Gray (CG) Forest Green (FG)

BENEFITS

- Does not contract
- No solvents, nontoxic, odourless, and safe for human health
- Effective on wet surfaces



CLEAR

Clear is a high-strength, multipurpose sealant that forms a clear, elastic seal after curing. It can be used on cladding, windows, doors, metal flashings, and other general construction applications. It bonds to painted metals, anodized aluminum, glass, vinyl, wood, masonry, polystyrene, and many engineering plastics.

CODE:

F1212 – 300 ml (10.1 oz) (24/pack)

BENEFITS

- Does not contract
- No solvents, nontoxic, odourless, and safe for human health
- No yellowing when exposed to UV rays



DURALINK 50

DuraLink 50 sealant creates a durable, highly elastic seal that forms a film in less than 40 minutes in a humid environment. It is designed to be applied to residential cladding, architectural metal, curtain wall constructions, and joints subject to movements. It adapts to joint movements of +/- 50%.

CODES:

F1260 – 300 ml (10.1 oz) (24/pack)
F1261 – 600 ml (20 oz) (12/pack)
F1210 – 825 ml (28 oz)
(Gray only)

Colours available:

White (WH) Gray (GR) Forest Green (FG) Limestone (LI)
Tan (TN) Dark Bronze (DB) Stone (ST) Aluminum (AG)
Medium Bronze (MB) Almond (AL) Terra Cotta (TR) Redwood Tan (RT)
Weathered Wood (WW)

BENEFITS

- Adheres to a variety of common construction materials
- Cures quickly
- Comes in a wide range of colours



DURASIL

DuraSil is a non-corrosive, multipurpose neutral silicone sealant and adhesive. It is used in a wide range of building and renovation applications, including windows, doors, roofs, and curtain walls.

CODE:

F1211 – 300 ml (10.1 oz) (24/pack)

BENEFITS

- Does not contract
- Remains stable up to 204 °C (400 °F)
- Effective on wet surfaces
- No vinegar smell



METALINK

CODE:
F1213 – 300 ml (10.1 oz) (12/pack)

MetaLink is a non-corrosive neutral silicone sealant designed specifically for use on metal substrates, including roofs, gutters, downspouts, walls, doors, and lighting fixtures. It adheres to aluminum, steel and copper, and offers exceptional adhesion to metals coated with PVDF Kynar 500™ and PVF Tedlar™. Its wide range of colours can be adapted to the current trends in decorative metal roofing and cladding products.

Colours available:

White (WH)	Black (BL)	Clear (CL)	Royal Blue (RB)	Regal Red (RR)	Terra Red (TRD)	Buck Skin (BS)
Colonial Red (CR)	Slate Gray (SLG)	Hartford Green (HG)	Mustang Brown (MSB)	Sierra Tan (SRT)	Shake Gray (SG)	Almond (AL)
Dark Bronze (BR)	Medium Bronze (MB)	City Scape (SC)	Mansard Brown (MDB)	Deep Charcoal (DC)	Charcoal Gray (CG)	Terra Cotta (TR)
Silver Metallic (SM)	Champagne Metallic (CM)	Copper Penny (CP)	Forest Green (FG)	Caramel (CA)		Brandywine (BW)

BENEFITS

- Does not contract
- No solvents, nontoxic, odourless, and safe for human health
- Does not contribute to metal corrosion



SNOWSHOES

A metal roof accessory that prevents snow and ice from falling. The installation completed without screws or mechanical fasteners prevents the risk of water infiltration on the roof.

CODES:
F1202 – 24/pack + 3 tubes of DURASIL
300 ml (10.1 oz)
F0951 – 192/pack
F0950 – 480/pack



BENEFITS

- Impact resistant
- Reduces the risk of injury
- Maintains the waterproofing of the roof metal coatings

COLOR CARD METALINK



COLOR CARD STANDARD PRODUCTS





RESISTO®

BUILDING PRODUCTS

Waterproofing Insulation Maintenance

1 877 478-8408 | resisto.ca